

CITY OF HIGH POINT

AGENDA ITEM



Title: Change Order – Final Adjusting
Boring of Conduits – Bid #5030-021319

From: Garey Edwards, PE; Electric Utilities Director
Tyler Berrier, PE; Electric Utilities Asst. Dir.

Meeting Date: June 3, 2019

Public Hearing: N/A

Advertised By: Purchasing

Attachments: Attachment A: Map
Attachment B: Subsurface Reports

PURPOSE:

Final adjusting change order for J & J Underground Utilities. This change order will close out the project and allow the Electric Utilities department to process final payment to the selected vendor for work performed under the contract for boring conduits for primary power in the Carol Bay subdivision. New primary wire was needed in the subdivision and heavy amounts of rock were encountered.

BACKGROUND:

The underground cable in the Carol Bay subdivision has reached the end of its service life as most of the cable was installed as underground in the early 1980's. After several attempts by internal staff, the Electric Utilities Department was unable to install conduits by digging because of large rock quantities. Staff solicited bids with a rock price added 1,673 linear feet of rock was encountered during construction resulting in the overrun of that bid item.

BUDGET IMPACT:

Funds are available in the operating budget for this change order.

RECOMMENDATION / ACTION REQUESTED:

City Council is requested to approve the change order to the J & J Underground Utilities contract in the amount of **\$197,869.00**.

OAK HOLLOW LAKE

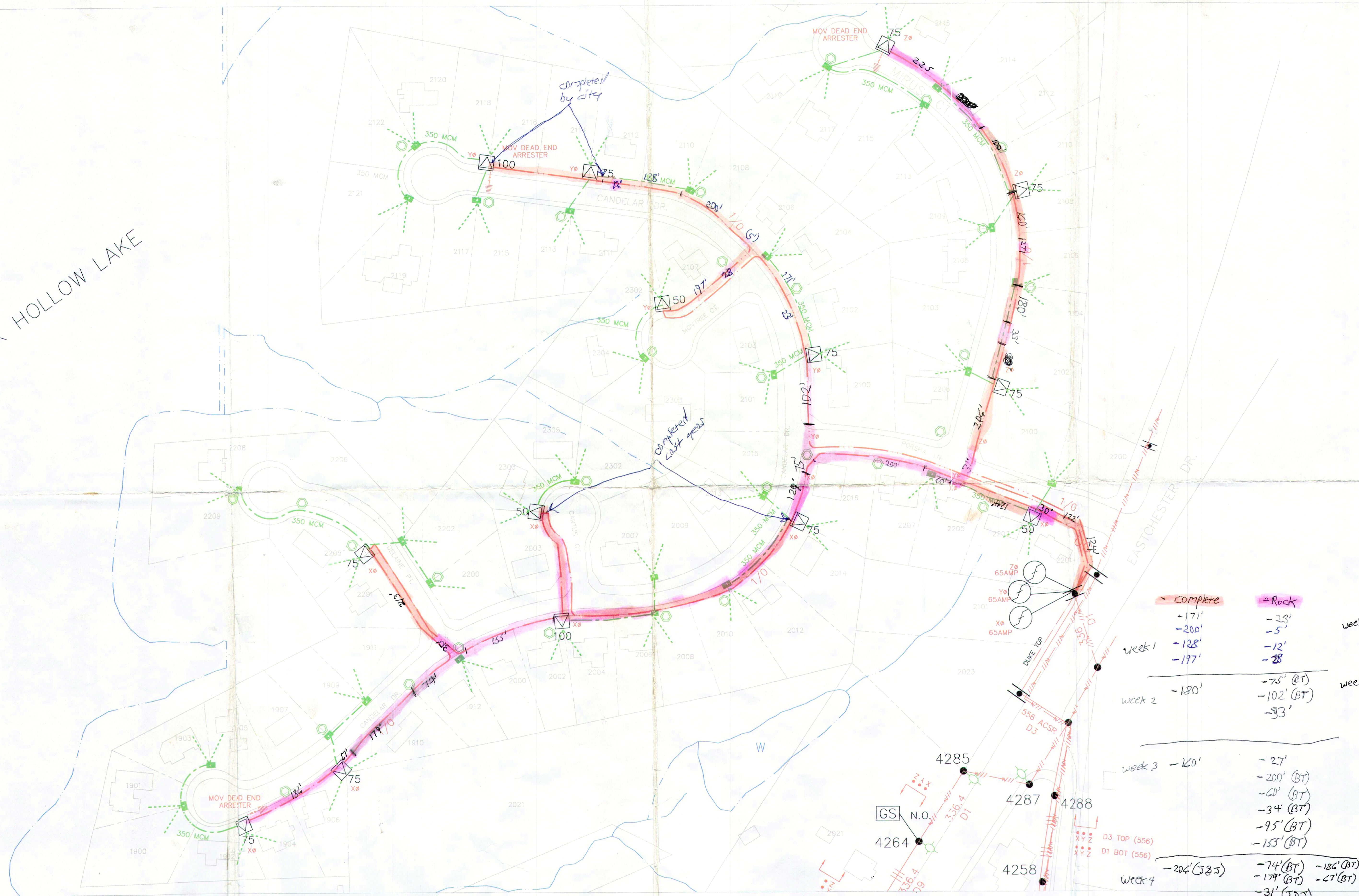

COLOR CODING SCHEME
PROPOSED PRIMARY FACILITIES
REMOVE/RELOCATE/TRANSFER
PROPOSED SECONDARY FACILITIES
EXISTING FACILITIES



OH UG
MTR MAT



CITY OF HIGH POINT - DEPARTMENT OF ELECTRIC UTILITIES - P.O. BOX 230, HIGH POINT, NC 27261 (336) 883-3134

CUSTOMER CONTRIBUTION OR ADVANCE: YES ☐ NO ☒ AMOUNT: \$
APPROVED BY: DATE: AS PER WORK LOAD
DATE TO BE STARTED: DATE TO BE COMPLETED: BY: ISSUED FOR CONSTR.:
SERVICE ORDER # COMPLETED BY: DATE:

CUSTOMER NAME: CAROL BAY SUBDIVISION ADDRESS: 2100 BLOCK EASTCHESTER DR.
DESCRIPTION OF WORK: X,Y,Z 15KV UG PRIMARY CABLE
350 MCM AL. SECONDARY TO HAND HOLES.
100W HPS TOWN&COUNTRY LIGHTS ON 16.0' FIBERGLASS POLES.
DRAWN BY: CB ENGINEER: OM/CB CHECKED BY: SCALE: 1"=XX
PAGE 1 OF 1 MAP LOCATION: GRID xxxxxx CIRCUIT: W.O. # 86-2401 ER: 1,2,6

Test Hole #1910 Candelar Dr. Vacuum Excavation Report

TIP#: N/A

DMP Project #: 180203

Project Description: Utility Soft Dig Locations (High Point, NC) Locate Depth of Rock

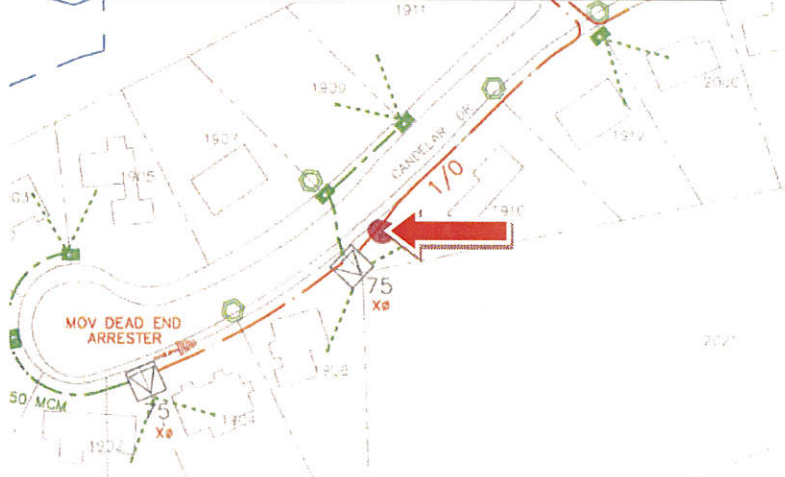
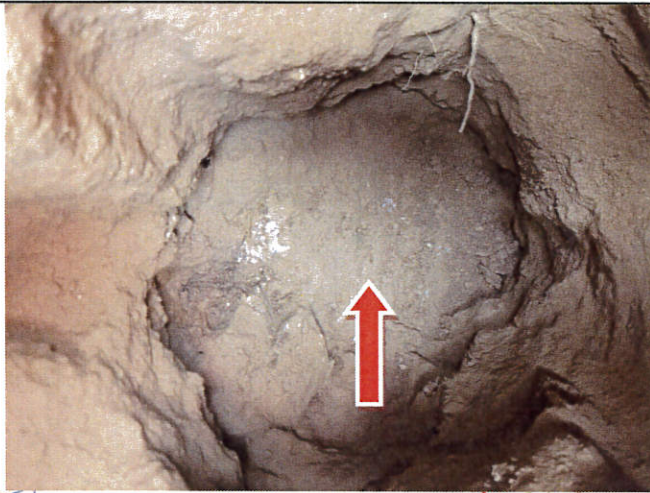

Test Hole Utility Information

Owner:	City of High Point
Type:	Rock
Size and Material:	N/A
Depth:	At 3.9' Encountered Rock
Top Elevation:	843.3' Top of Rock
Northing:	827,475.3
Easting:	1,710,220.6

Baseline Station and Offset

Design Alignment Station and Offset

Project Datum Description:

Project Control was provided by Davis Martin Powell
Types of GPS field procedure: RTK
Dates of survey: 8/26/2018
Datum/Epoch: NAD 83 (2011)
Published/Fixed Control use: NC RTN
Geoid Model: 12A
Combined Grid Factor=0.999926947
Units: US Survey Foot

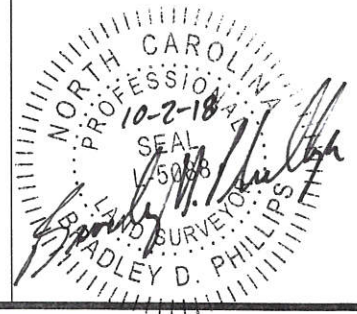

Test Hole #1911 Candelar Dr. Vacuum Excavation Report

TIP#: N/A

DMP Project #: 180203

Project Description: Utility Soft Dig Locations (High Point, NC) Locate Depth of Rock

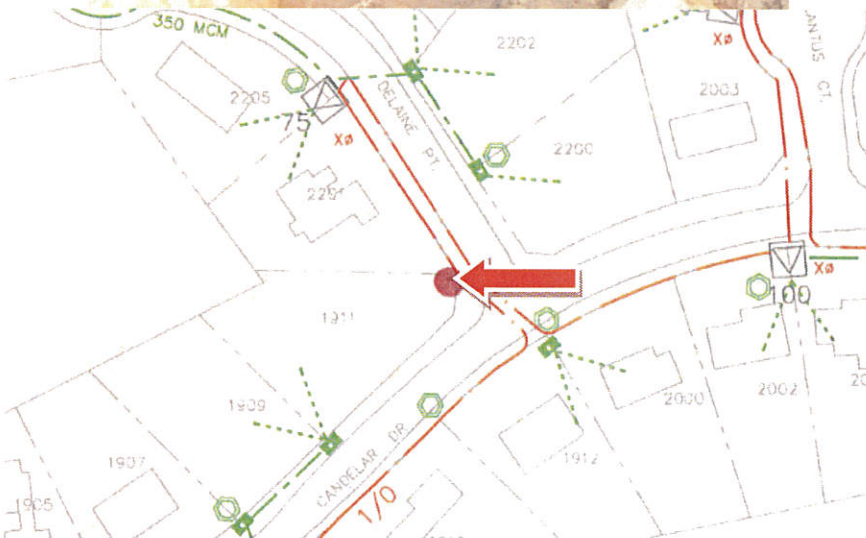

Test Hole Utility Information

Owner:	City of High Point
Type:	Rock
Size and Material:	N/A
Depth:	5.2' Encountered Minimal Rock
Ground Elevation:	848.4'
Northing:	827,676.1
Easting:	1,710,354.4

Baseline Station and Offset

Design Alignment Station and Offset

Project Datum Description:

Project Control was provided by Davis Martin Powell

Types of GPS field procedure: RTK

Dates of survey: 8/26/2018

Datum/Epoch: NAD 83 (2011)

Published/Fixed Control use: NC RTN

Geoid Model: 12A

Combined Grid Factor=0.999926834

Units: US Survey Foot

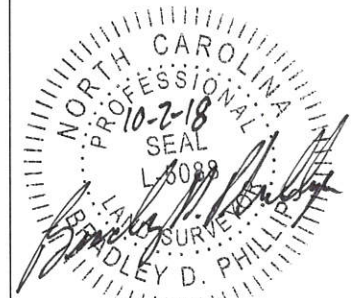

Test Hole #2004 Candelar Dr. Vacuum Excavation Report

TIP#: N/A

DMP Project #: 180203

Project Description: Utility Soft Dig Locations (High Point, NC) Locate Depth of Rock



Test Hole Utility Information

Owner:	City of High Point
Type:	Rock
Size and Material:	N/A
Depth:	At 4.4' Encountered Rock
Top Elevation:	856.8' Top of Rock
Northing:	827,705.8
Easting:	1,710,670.8

Baseline Station and Offset

Design Alignment Station and Offset

Project Datum Description:

Project Control was provided by Davis Martin Powell

Types of GPS field procedure: RTK

Dates of survey: 8/26/2018

Datum/Epoch: NAD 83 (2011)

Published/Fixed Control use: NC RTN

Geoid Model: 12A

Combined Grid Factor=0.999926453

Units: US Survey Foot

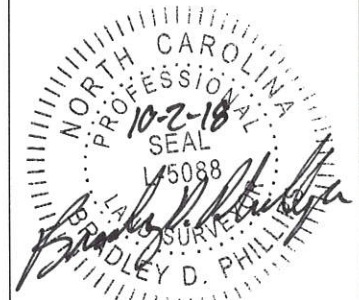

Test Hole #2016 Candelar Dr. Vacuum Excavation Report

TIP#: N/A

DMP Project #: 180203

Project Description: Utility Soft Dig Locations (High Point, NC) Locate Depth of Rock

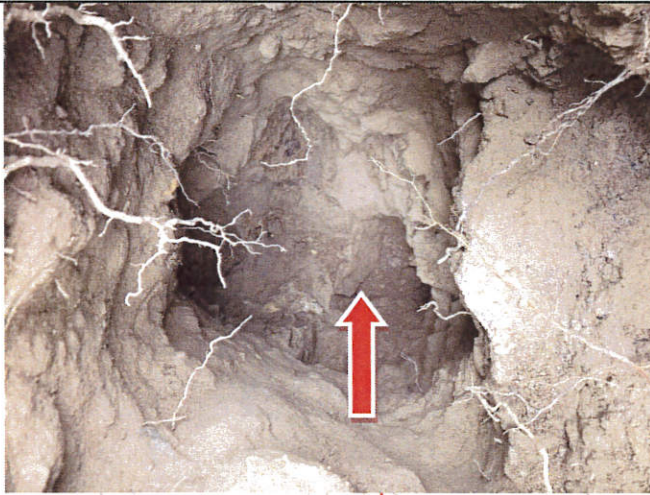

Test Hole Utility Information

Owner:	City of High Point
Type:	Rock
Size and Material:	N/A
Depth:	At 2.4' Encountered Rock
Top Elevation:	859.8' Top of Rock
Northing:	827,885.9
Easting:	1,710,981.5

Baseline Station and Offset

Design Alignment Station and Offset

Test Hole was moved due to bushes and driveway.

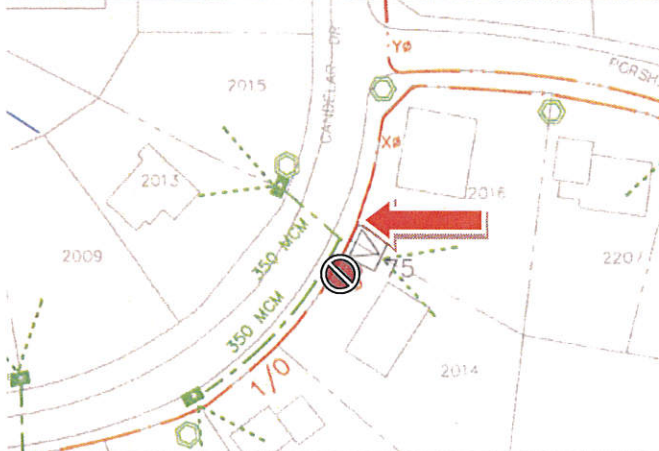

Project Datum Description:

Project Control was provided by Davis Martin Powell
Types of GPS field procedure: RTK
Dates of survey: 8/26/2018
Datum/Epoch: NAD 83 (2011)
Published/Fixed Control use: NC RTN
Geoid Model: 12A
Combined Grid Factor=0.999926428
Units: US Survey Foot



Test Hole #2104 Candelar Dr. Vacuum Excavation Report

TIP#: N/A

DMP Project #: 180203

Project Description: Utility Soft Dig Locations (High Point, NC) Locate Depth of Rock



Test Hole Utility Information

Owner:	City of High Point
Type:	Rock
Size and Material:	N/A
Depth:	At 3.8' Encountered Rock
Top Elevation:	851.3' Top of Rock
Northing:	828,301.2
Easting:	1,710,948.1

Baseline Station and Offset

Design Alignment Station and Offset

Project Datum Description:

Project Control was provided by Davis Martin Powell

Types of GPS field procedure: RTK

Dates of survey: 8/27/2018

Datum/Epoch: NAD 83 (2011)

Published/Fixed Control use: NC RTN

Geoid Model: 12A

Combined Grid Factor=0.999927100

Units: US Survey Foot



Test Hole #2104 Mirus Ct. Vacuum Excavation Report

TIP#: N/A

DMP Project #: 180203

Project Description: Utility Soft Dig Locations (High Point, NC) Locate Depth of Rock

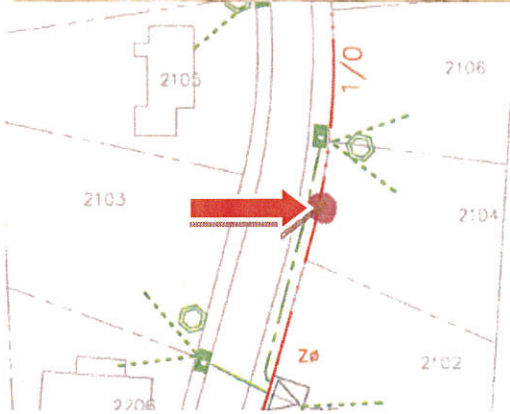
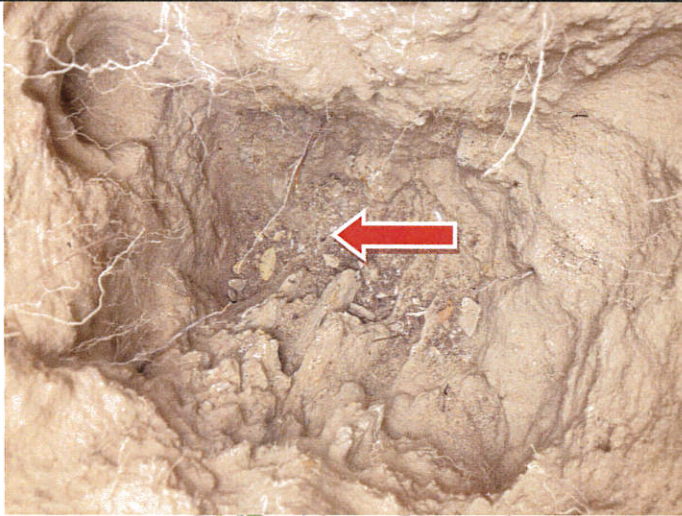

Test Hole Utility Information

Owner:	City of High Point
Type:	Rock
Size and Material:	N/A
Depth:	At 2.5' Encountered Rock
Top Elevation:	865.7' Top of Rock
Northing:	828,213.8
Easting:	1,711,365.2

Baseline Station and Offset

Design Alignment Station and Offset

Project Datum Description:

Project Control was provided by Davis Martin Powell

Types of GPS field procedure: RTK

Dates of survey: 8/27/2018

Datum/Epoch: NAD 83 (2011)

Published/Fixed Control use: NC RTN

Geoid Model: 12A

Combined Grid Factor=0.999926235

Units: US Survey Foot



Test Hole #2107 Montree Ct. Vacuum Excavation Report

TIP#: N/A

DMP Project #: 180203

Project Description: Utility Soft Dig Locations (High Point, NC) Locate Depth of Rock

Test Hole Utility Information

Owner:	City of High Point
Type:	Rock
Size and Material:	N/A
Depth:	At 4.4' Encountered Minimal Rock
Ground Elevation:	845.9'
Northing:	828,215.1
Easting:	1,710,776.3

Baseline Station and Offset

Design Alignment Station and Offset

Test Hole was moved due to trees.

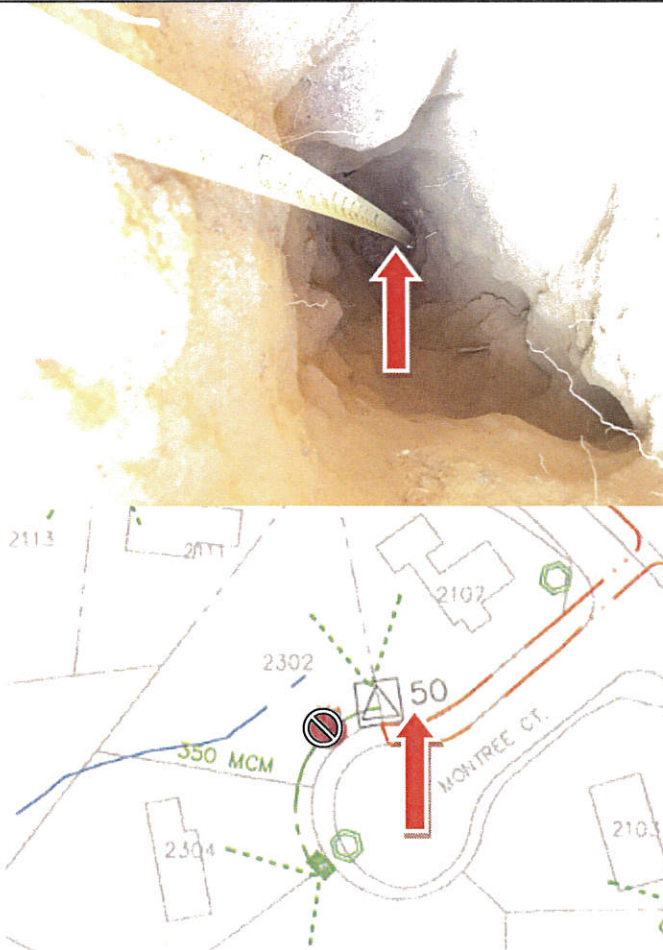

Project Datum Description:

Project Control was provided by Davis Martin Powell
Types of GPS field procedure: RTK
Dates of survey: 8/26/2018
Datum/Epoch: NAD 83 (2011)
Published/Fixed Control use: NC RTN
Geoid Model: 12A
Combined Grid Factor=0.999927303
Units: US Survey Foot

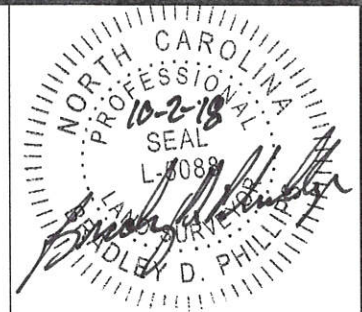

Test Hole #2110 Candelar Dr. Vacuum Excavation Report

TIP#: N/A

DMP Project #: 180203

Project Description: Utility Soft Dig Locations (High Point, NC) Locate Depth of Rock

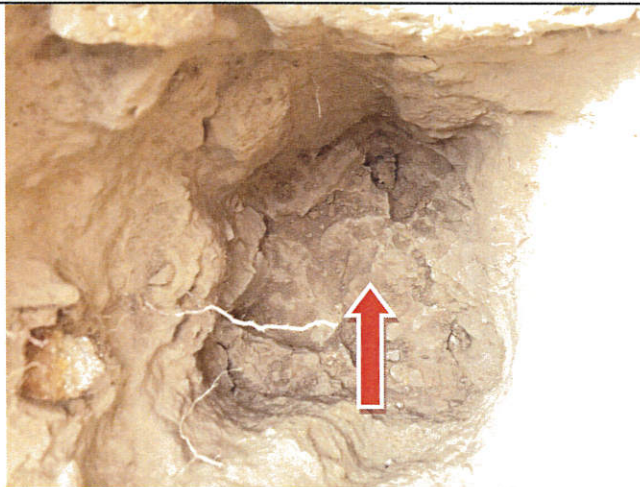

Test Hole Utility Information

Owner:	City of High Point
Type:	Rock
Size and Material:	N/A
Depth:	At 1.6' Encountered Rock
Top Elevation:	847.8' Top of Rock
Northing:	828,411.5
Easting:	1,710,792.7

Baseline Station and Offset

Design Alignment Station and Offset

Test Hole was moved due to trees.

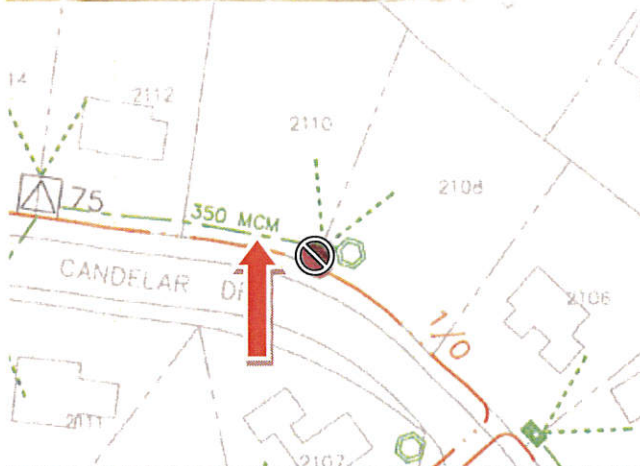

Project Datum Description:

Project Control was provided by Davis Martin Powell

Types of GPS field procedure: RTK

Dates of survey: 8/26/2018

Datum/Epoch: NAD 83 (2011)

Published/Fixed Control use: NC RTN

Geoid Model: 12A

Combined Grid Factor=0.999927336

Units: US Survey Foot

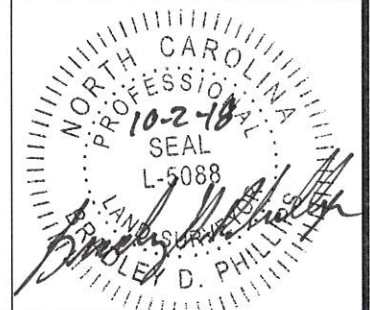

Test Hole #2114 Mirus Ct. Vacuum Excavation Report

TIP#: N/A

DMP Project #: 180203

Project Description: Utility Soft Dig Locations (High Point, NC) Locate Depth of Rock

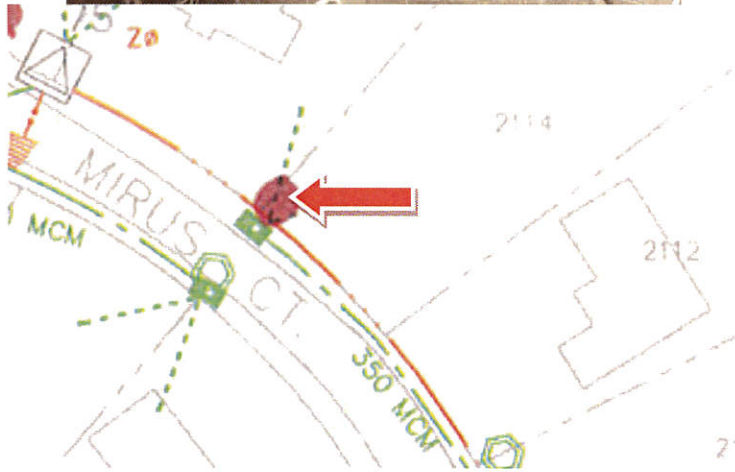

Test Hole Utility Information

Owner:	City of High Point
Type:	Rock
Size and Material:	N/A
Depth:	At 2.6' Encountered Rock
Top Elevation:	852.5' Top of Rock
Northing:	828,608.7
Easting:	1,711,256.3

Baseline Station and Offset

Design Alignment Station and Offset

Project Datum Description:

Project Control was provided by Davis Martin Powell

Types of GPS field procedure: RTK

Dates of survey: 8/27/2018

Datum/Epoch: NAD 83 (2011)

Published/Fixed Control use: NC RTN

Geoid Model: 12A

Combined Grid Factor=0.999927241

Units: US Survey Foot



Test Hole #2118 Mirus Ct. Vacuum Excavation Report

TIP#: N/A

DMP Project #: 180203

Project Description: Utility Soft Dig Locations (High Point, NC) Locate Depth of Rock

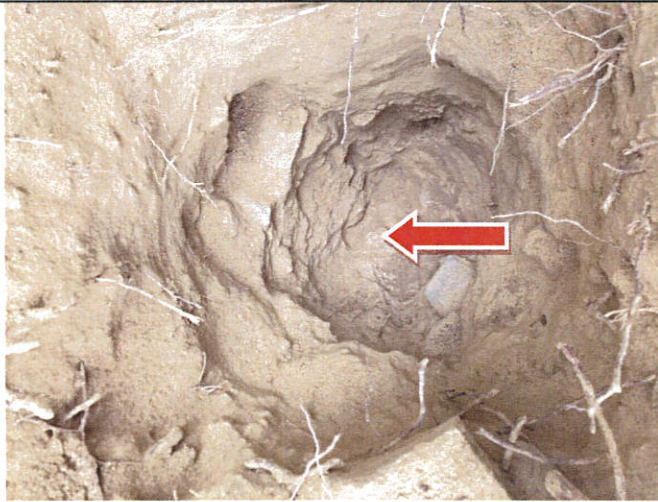

Test Hole Utility Information

Owner:	City of High Point
Type:	Rock
Size and Material:	N/A
Depth:	At 2.2' Encountered Rock
Top Elevation:	850.5' Top of Rock
Northing:	828,718.3
Easting:	1,711,112.0

Baseline Station and Offset

Design Alignment Station and Offset

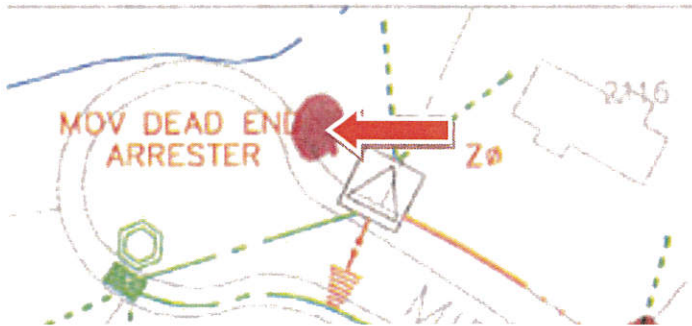

Project Datum Description:

Project Control was provided by Davis Martin Powell
Types of GPS field procedure: RTK
Dates of survey: 8/27/2018
Datum/Epoch: NAD 83 (2011)
Published/Fixed Control use: NC RTN
Geoid Model: 12A
Combined Grid Factor=0.999927411
Units: US Survey Foot

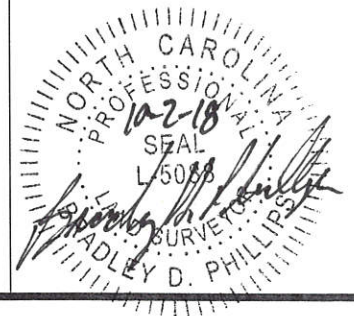

Test Hole #2207 Porsha Ln. Vacuum Excavation Report

TIP#: N/A

DMP Project #: 180203

Project Description: Utility Soft Dig Locations (High Point, NC) Locate Depth of Rock

Test Hole Utility Information

Owner:	City of High Point
Type:	Rock
Size and Material:	N/A
Depth:	5.3' Encountered Minimal Rock
Ground Elevation:	859.9'
Northing:	827,958.8
Easting:	1,711,232.9

Baseline Station and Offset

Design Alignment Station and Offset



Test Hole was moved due to bushes and driveway.

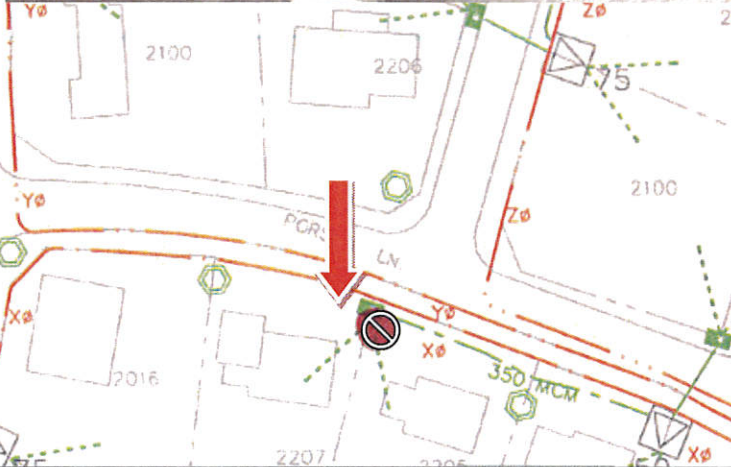

Project Datum Description:

Project Control was provided by Davis Martin Powell
Types of GPS field procedure: RTK
Dates of survey: 8/27/2018
Datum/Epoch: NAD 83 (2011)
Published/Fixed Control use: NC RTN
Geoid Model: 12A
Combined Grid Factor=0.999926726
Units: US Survey Foot

