



high pint
BREWERY & PUBLIC HOUSE

High Pint will be a pleasant & cultivated place where people go to enjoy great beverages, food, and getting together with their friends & family.



- The High Pint Brew House will be a Belgian designed system.
- Bom Brew a 3 vessel, 15 BBL Brew-house system.
- Beer Styles: Pilsners, Brown & Pale Ales, IPA's, Lagers, Porters, Sours, Wheats, Stouts, Belgian, and Lite or Session Beers.
- Seltzers.
- Non Alcoholic: Craft Coffee, Fruity Kombucha Flavors, Fresh Fruit Craft Sodas and Ciders.
- Local Craft Wines & Spirits, with a focus on North Carolina products.

Meet the Team



Cindy Fila, President, is from Asheboro, NC and has a passion for life and people. She has had a stellar career in the beauty industry and is taking all her life experiences to lead the High Pint brand. Cindy's career has taken her all over the country and now back to her roots and her family in North Carolina. A true people person, she is very excited to begin this new journey with High Pint.

Larry Fila, CEO, is from Baltimore, MD and has extensive leadership experience in the for-profit and not-for-profit sectors. Larry, a true entrepreneur's, journey began when he started shining shoes in a local barber shop in fourth grade. A long the way, he has owned multiple business in multiple states. Currently he is the President of the Baltimore Indoor Lacrosse League and the not for profit Premier Series Lacrosse. The first head coach for the Slovakian National Box Lacrosse Team, which made it inaugural appearance in the 2019 World Indoor Lacrosse Championships this past September in Langley BC, Canada. Larry's love for beer started when he spent his 16th Birthday in the Hofbrauhaus in Munich, Germany in 1978. He is very excited about the team that is starting this venture and looks forward to working with them to grow the High Pint brand.

Haley Hines, Marketing and Event Coordinator, was born in North Carolina and spent her early childhood here in the Carolina's, then spent 17 years in Maryland. She earned her Bachelor's & Master's Degree in Business Administration, concentration in Marketing from Frostburg Stated University, where she was also a 4 year starter for the women's lacrosse program. She is looking forward to putting her degree to work in the world of High Pint.

Meet the Team



Ryan Hice, VP of Sales: has had a passion for craft beer, spirits (flavored moonshine) and wine from production to end product since college. A decade long finance career later he made the transition to brewery equipment sales. Sold for both import and USA made manufactures with brewery builds both large and small across the map. Seen the good, the bad and the ugly. Watched breweries struggle through financial, production and process hurdles and achieve great success . Currently working with Belgian brewer and designer, Bert Van Hecke and his company bbrew.be on projects across the globe from planning to install. Looking forward to working with the talented team we have assembled.

Brendan Scholfield, Brewery Operations Leader: Graduated from UNC Greensboro with a B.A. in 2004, and UL Lafayette with a M.M. in 2006. For the last 13 years Brendan has worked in the Food and Beverage industry. Making a transition to the brewing industry in 2015 where he started as an assistant brewer and worked up to becoming lead brewer in 2017.

Master Brewer, Has won 40+ beer medals from 2000-2019 in GABF, NC Brewer's Cup, Carolina Championship of Beer. World Brewing Academy's: Siebel Institute of Technology & Doemens Academy.

High Pint Brewery & Public House
1114 Eastchester Drive High Point, NC
Building Upfit



High Pint Brewery & Public House
1114 Eastchester Drive High Point, NC
Building Upfit





ROBERT C. CARTER, AIA
 State of North Carolina
 License No. 10000

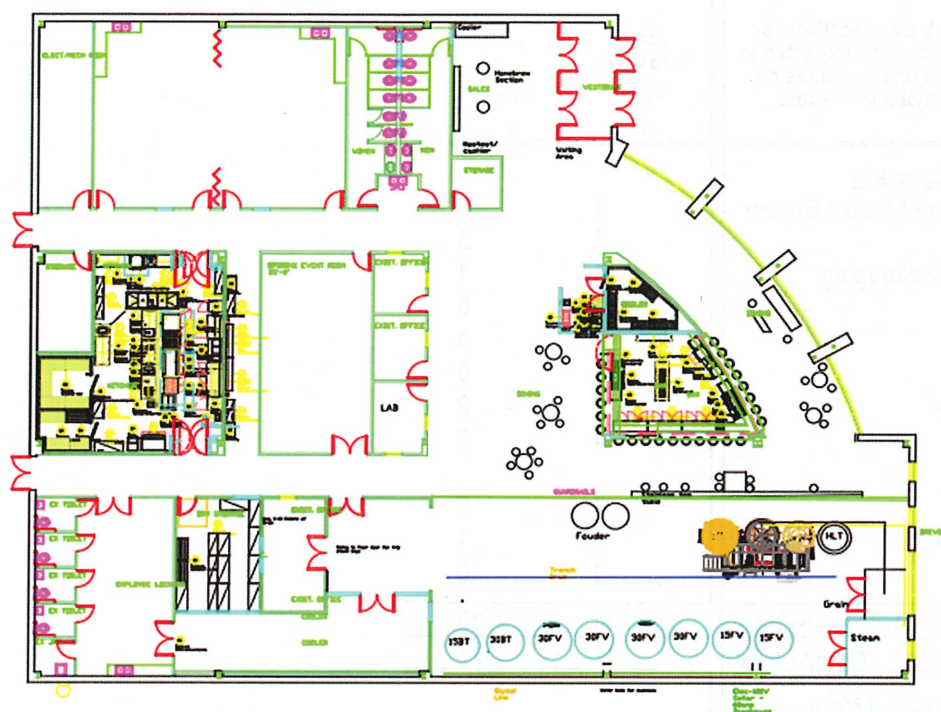

FLOOR PLAN

1/8" = 1'-0"



PRELIMINARY
 NOT FOR CONSTRUCTION

HIGH PINTINDREW BREWERY
 BREWERY

NORTH CAROLINA

1114 EASTOKEST DRIVE

HIGH POINT



DATE	10-01
BY	J.C.
CHECKED	J.C.
APPROVED	J.C.
SCALE	1/8" = 1'-0"
PROJECT	HIGH PINTINDREW BREWERY
DATE	10-01
BY	J.C.
CHECKED	J.C.
APPROVED	J.C.
SCALE	1/8" = 1'-0"
PROJECT	HIGH PINTINDREW BREWERY
DATE	10-01
BY	J.C.
CHECKED	J.C.
APPROVED	J.C.
SCALE	1/8" = 1'-0"
PROJECT	HIGH PINTINDREW BREWERY

A1

Job Creation



Provide general job classifications for the permanent full-time jobs expected to be created by the project. Please do not simply list all jobs in one row.

Employees of the Company

Iron Door Brewery Master Brewer
Brewers
Accounting / Bookkeeping
CEO
President
Sales VP
Sales Managers
Sales Staff

Barrel Manager
Beer Cellar Manager
Marketing

Total for Grantee - By Year

Total for Grantee - Running Total

Employees of the Related Member

Special Event Staff
Brewery Staff

Jobs Created In	
Year	Year
1	2
1	0
1	3
1	1
1	0
1	0
1	0
1	2
4	6
1	0
1	1
1	0
14	13
14	27

Connecting with the Community



Schools: HPU, GTCC, High Schools, Elementary Schools. Connecting with Students, Faculty & Staff through sports teams, clubs and organization.

High Point Rockers: Pregame & post game activities, coaches & player interviews, hosting meet and greets.

Family & Community Events: Oktoberfest, Beverage & Food Festivals, Entertainment: Live Music, Comedy Acts, Theater and Family Movie Nights.

Fundraisers: Locally and beyond.

Collaborations with local organizations: High Point Theater, High Point Museum, John Coltrane International Music Festival, High Point Market, Show Time Fabric Market, All-A-Flutter Butterfly Farm, Operation 36 Golf, Triad Golf, North Carolina Zoo...

B2B Events and networking: Through the High Point Chamber, High Point Junior League, Rotary Club, BNI, Kiwanis Club, Guilford Green, High Point's Internationally based companies ...



high pint
BREWERY & PUBLIC HOUSE